

CURVED BEAM CB-1
24F-V3
5" x VARIES

8-req'd.

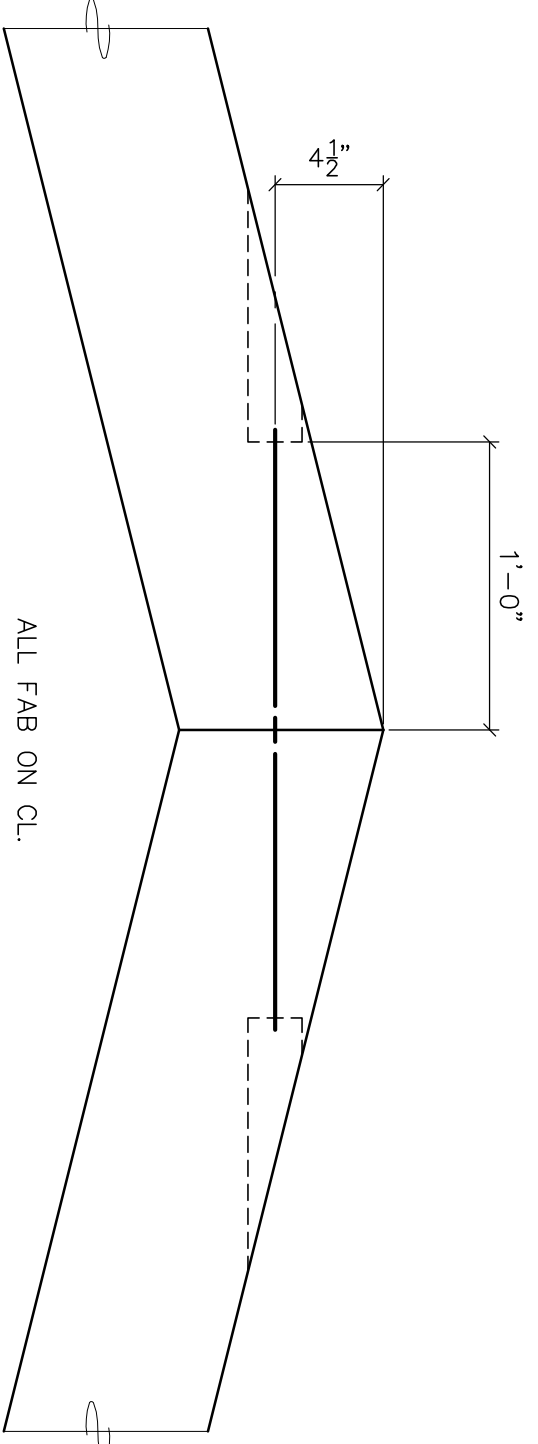

ALL FAB ON CL.

ERECTOR NOTE:
DRILL 5/32\"/>

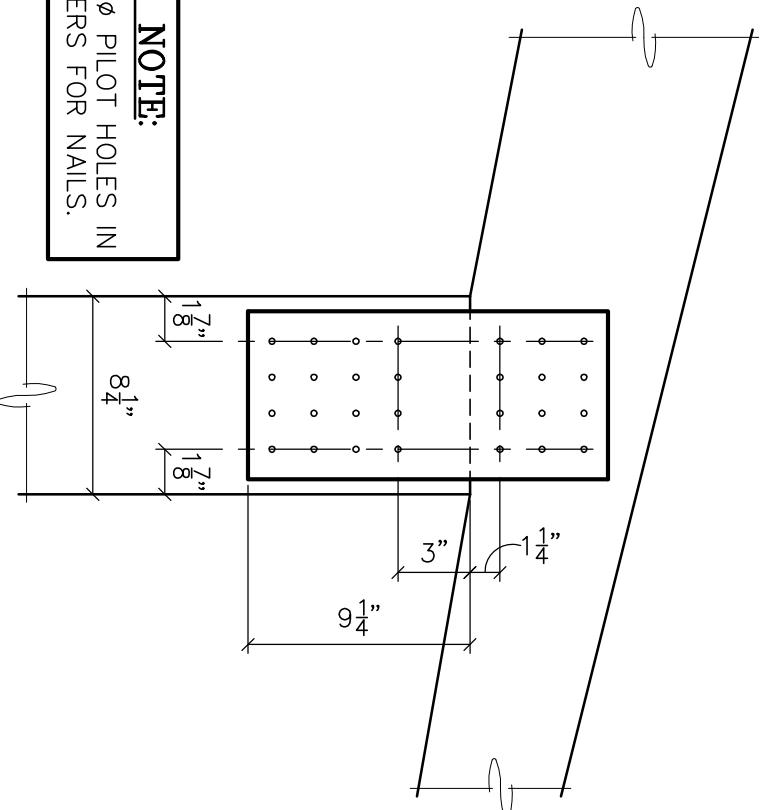

CONN S-2

1-req'd.

- 1 - 3/4" x 26" THREADED ROD
- 2 - 3/4" HEX NUT
- 2 - 3/4" WASHER

CONN S-1

8-req'd.

- 2 - MK-1 PLATE (SP000007X15A00.2500)
- 56 - 4 GA. x 2 1/2" ANNULAR RING NAIL, GALV.

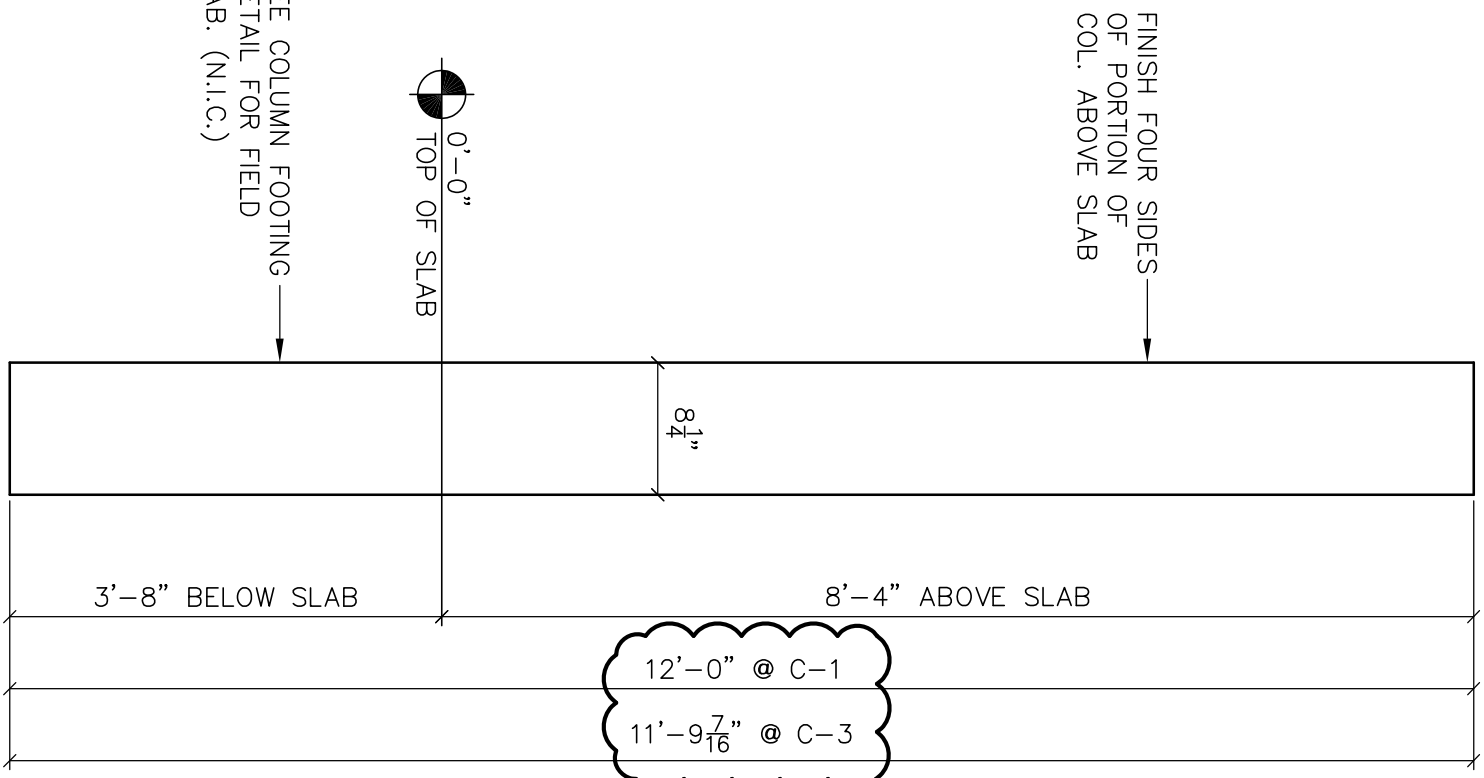

COLUMN C-1
24F-V5
TREATED
5" x 8 1/4"

6-req'd.

COLUMN C-3
24F-V5
TREATED
5" x 8 1/4"

2-req'd.

COLUMN C-2
47(L: 8) w/o T. LAMS
TREATED
5" x 5 1/2"

4-req'd.

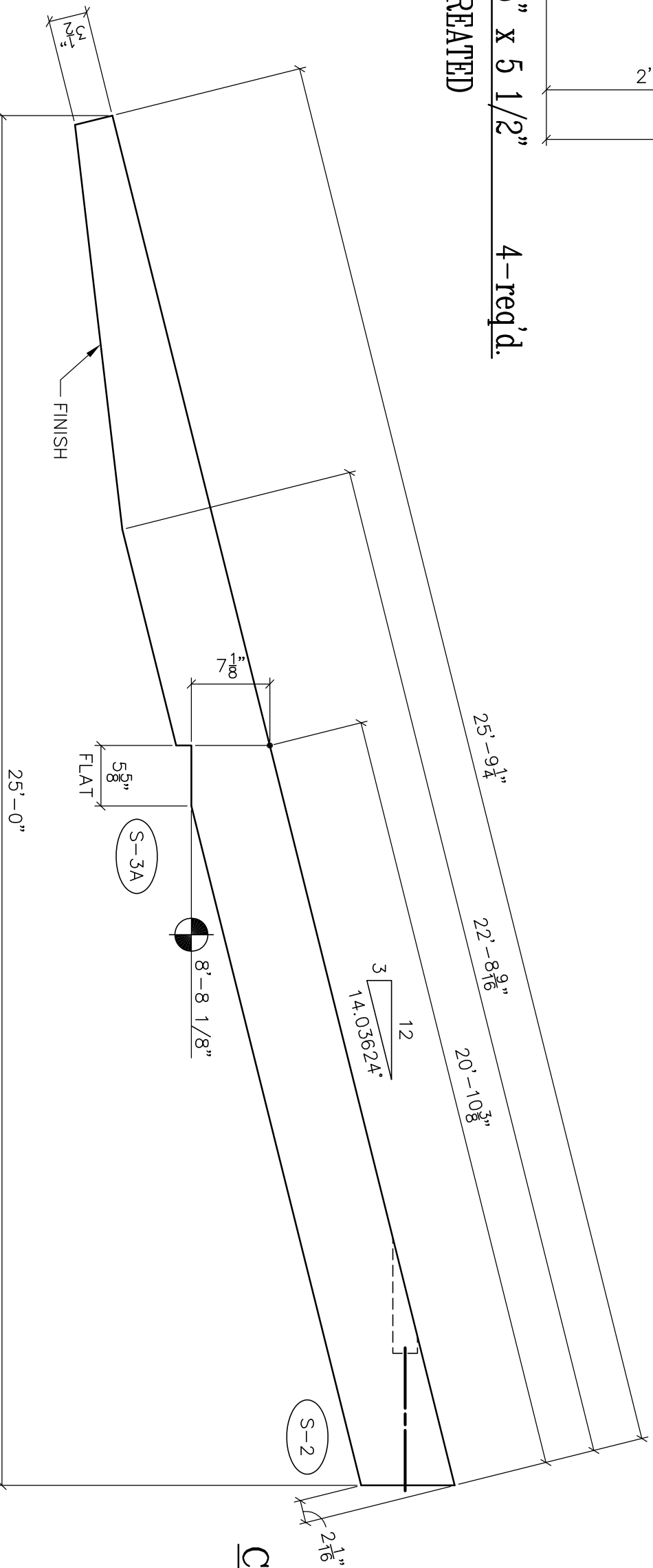

RAFTER R-1
24F-V3
5" x 8 1/4"

2-req'd.

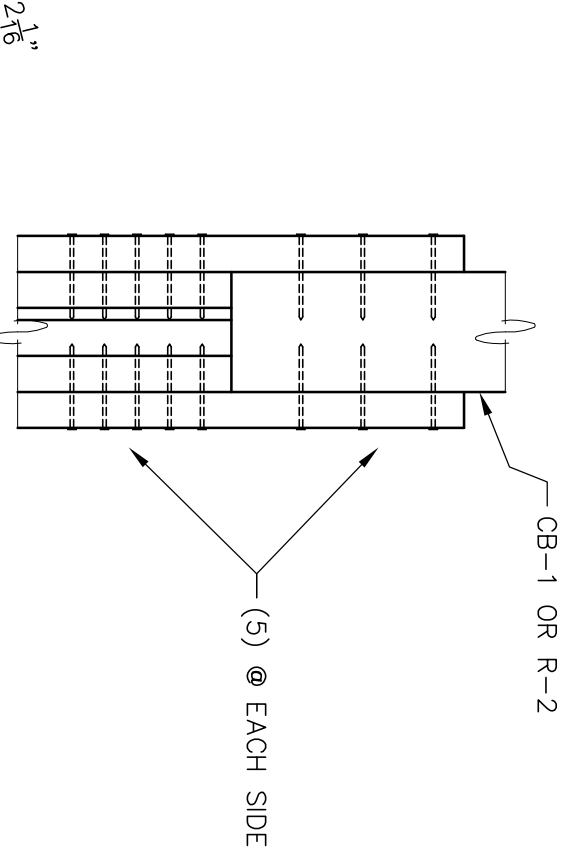

CONN S-3
20 - 16d NAIL
16-req'd.

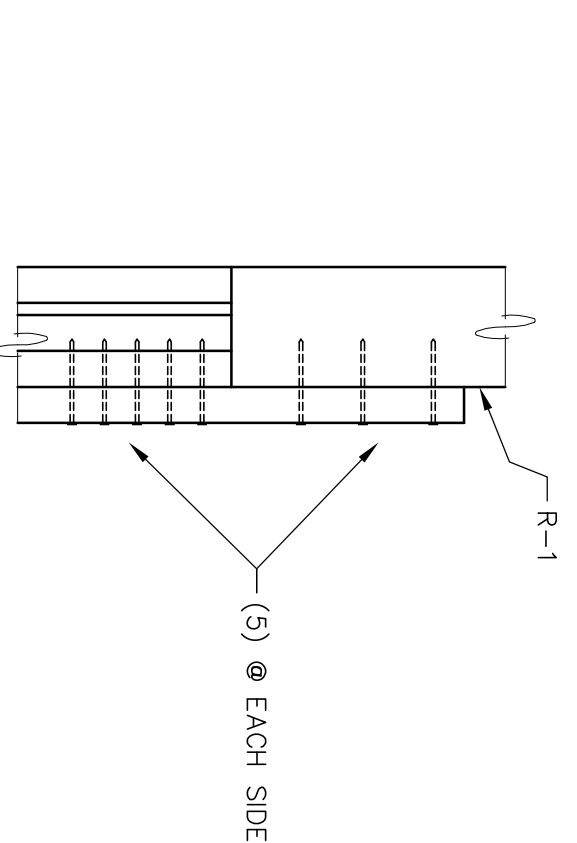

CONN S-3A
10 - 16d NAIL
2-req'd.

PROJ. NO.:

08-289

DRAWN: JLD 11-11-08

CHK'D: RDS 12-8-08

DESIGN: YES 12-8-08

REV 1: CUT 6-10-09

REV 2:

REV 3:

REV 4:

CAD NO.: 7360 RS

ECG JOB NO.: 7360 R V

SHEET NO.:

5 OF 9

RCP SHELTERS, INC.

2100 SE RAYS WAY STUART, FL 34994

- SHELTERS
- RESTROOMS

- PAVILIONS
- BANDSHELLS

Phone 800-525-0207
www.rcpselters.com

PO BOX 25 STUART, FL 34995-0025

- CONCESSIONS
- MINI-SHELTERS
- KIOSKS
- DUGOUTS

Fax 772-288-0207
Email info@rcpselters.com

LW-G50100-03-ENC-3FSC
COMMUNITY PARK
BOILING SPRINGS, PA

THIS PRINT IS THE PROPERTY OF RCP SHELTERS, INC. IT IS TO BE USED ONLY FOR THE PROJECT AND NOT TO BE REPRODUCED WITHOUT PERMISSION.